

PRIME DESIGN™

A Safe Fleet Brand

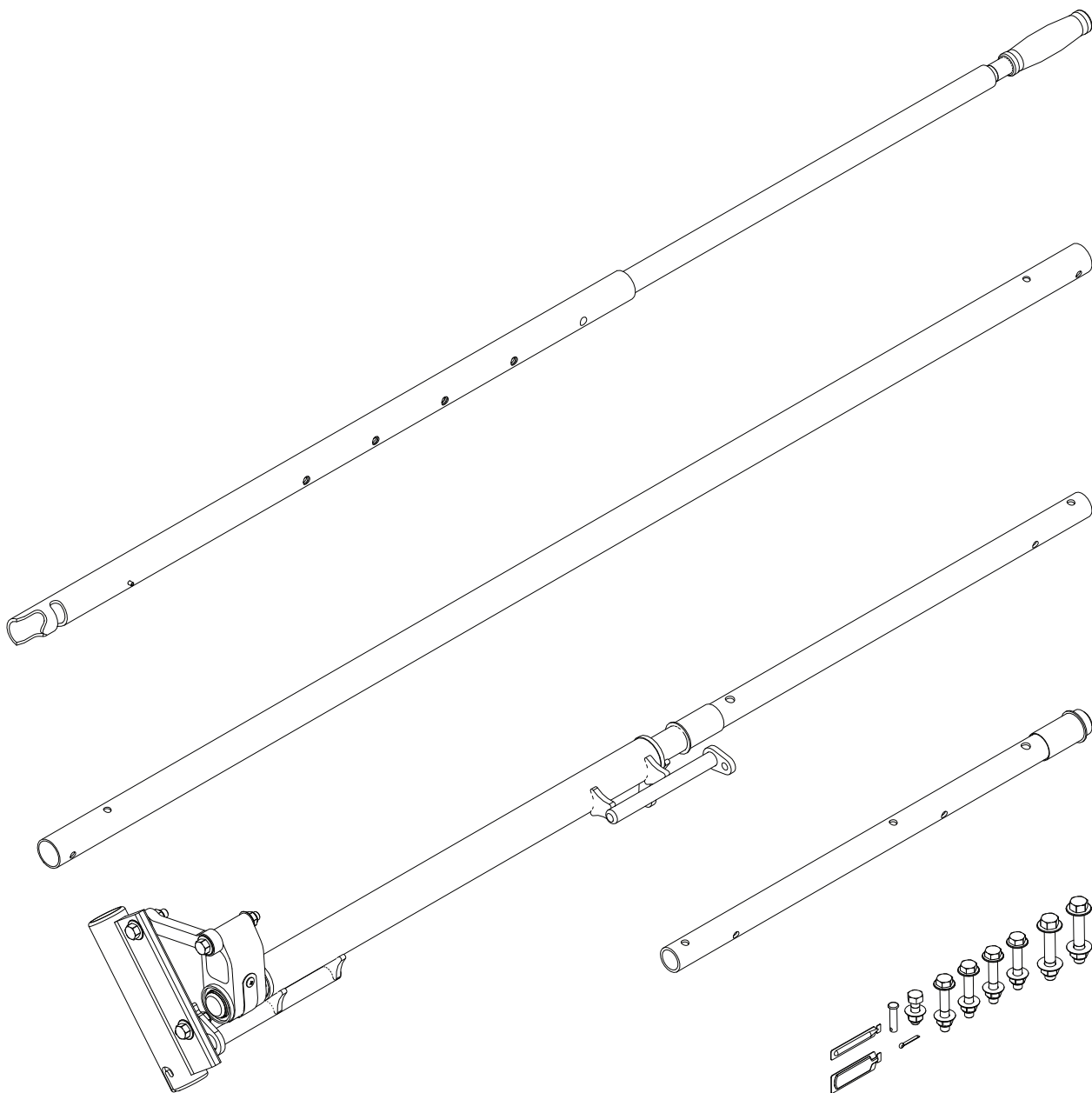

RIGHT SIDE DRIVE SHAFT KIT, HIGH ROOF

PRIME DESIGN, A SAFE FLEET BRAND • Address: 1689 Oakdale Avenue #102, West St Paul, Minnesota 55118
Toll Free: 1.8.PRIME.RACK • Fax: 651-552-1799 • Email: info@primedesign.net • Website: www.primedesign.net

FEA0019

CONTENTS OVERVIEW

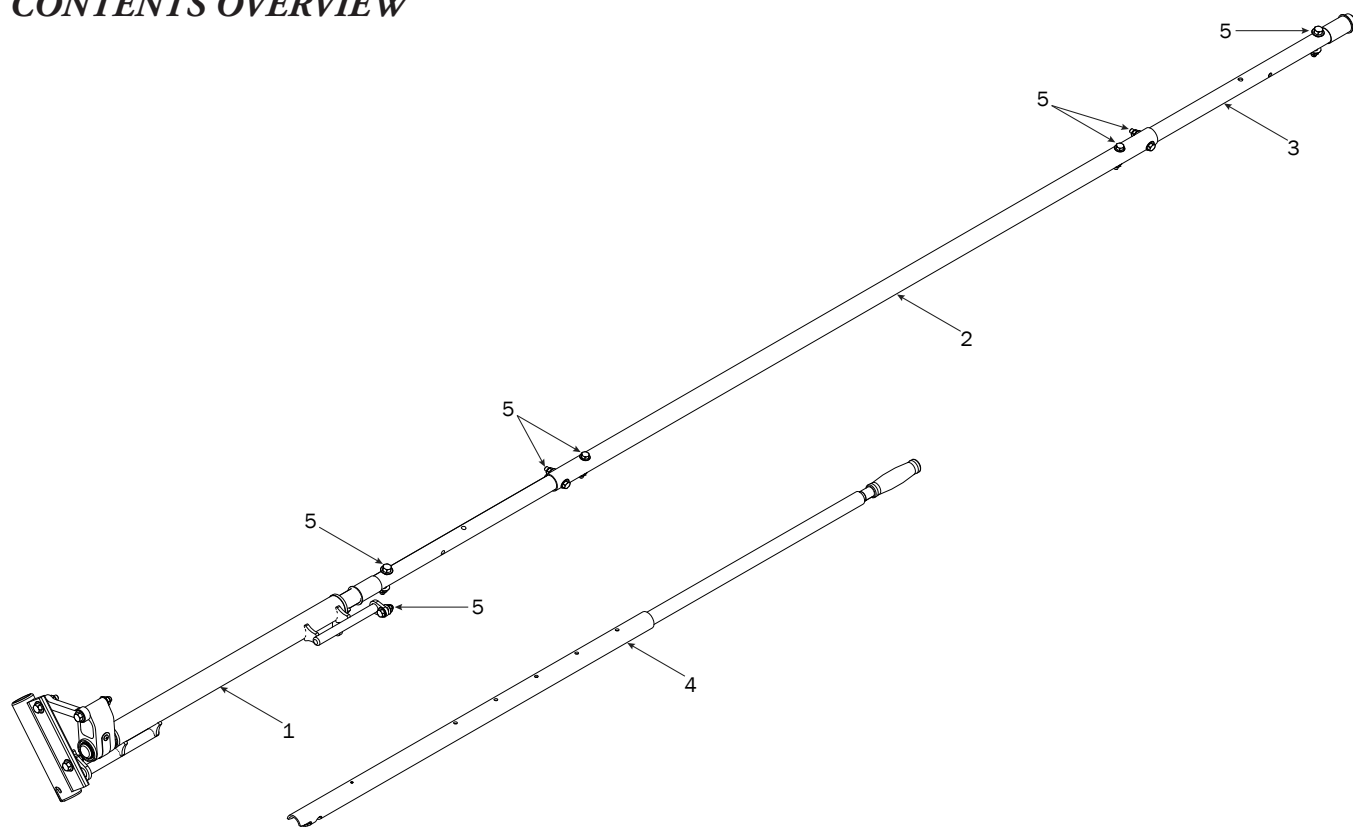

1—Drive Shaft (Qty 1)
Rear, Right Hand, 50.00"

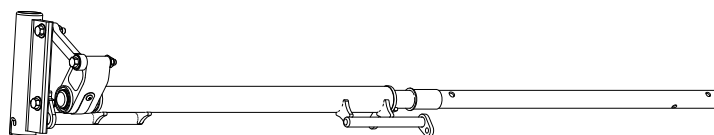

2—Connecting Bar (Qty 1)
60.00"

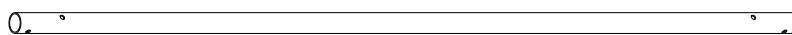

3—Front Drive Shaft (Qty 1)
B Version, 23.75"

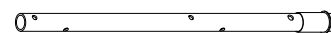

4—HRR Handle Assembly (Qty 1)
Removable, 35.00"



5—HKT-8163..... (Qty 1)
Modular High Roof Rotation Hardware Kit



Cotter Pin (1X)

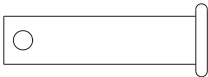

Clevis Pin (1X)



M8 x 50MM (4X)

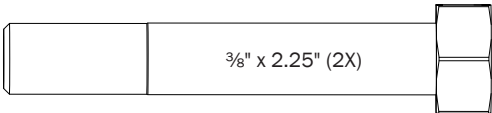

3/8" x 2.25" (2X)



M8 x 25MM (1X)

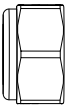

M8 Lock Nut (5X)

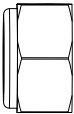

3/8" Lock Nut (2X)

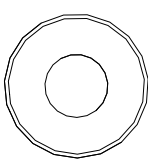

5/16" Flat Washer (10X)

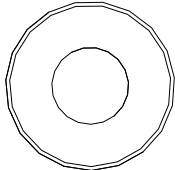

3/8" Flat Washer (4X)

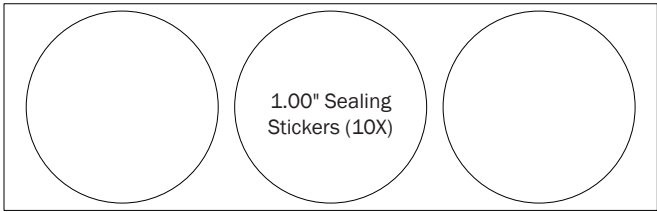

1.00" Sealing
Stickers (10X)



Anti-Seize (1X)

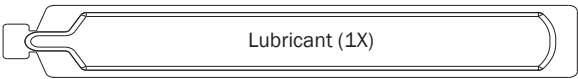

Lubricant (1X)

**RIGHT DRIVE SHAFT
ASSEMBLY SEQUENCE**

NOTE: Crossbars and RH Rotation feature are shown for illustrative purposes only. Crossbars and Rotations are not included with this Drive Shaft feature, and must be purchased separately.

NOTE: Flow Control Screw faces toward vehicle rear

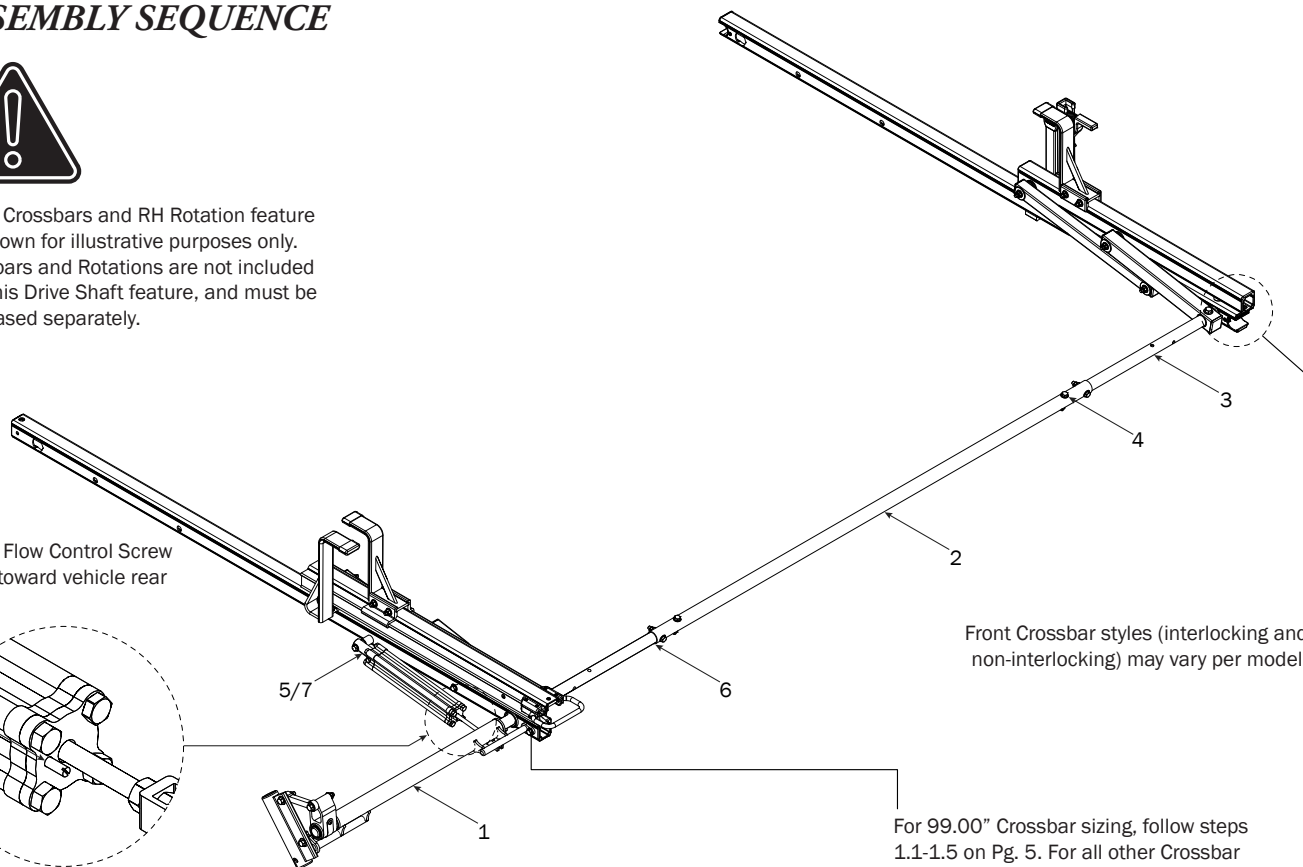
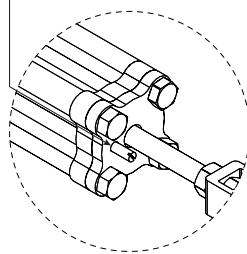
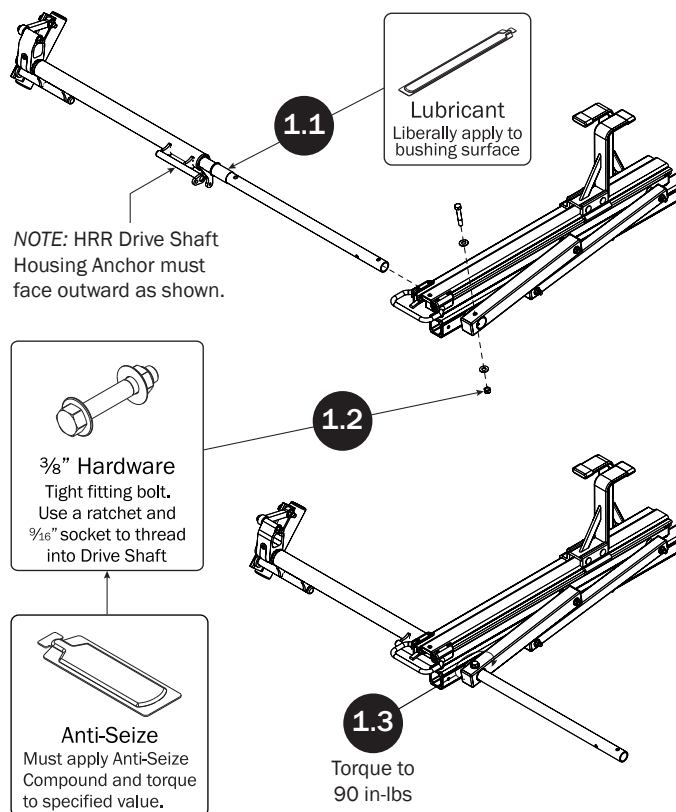
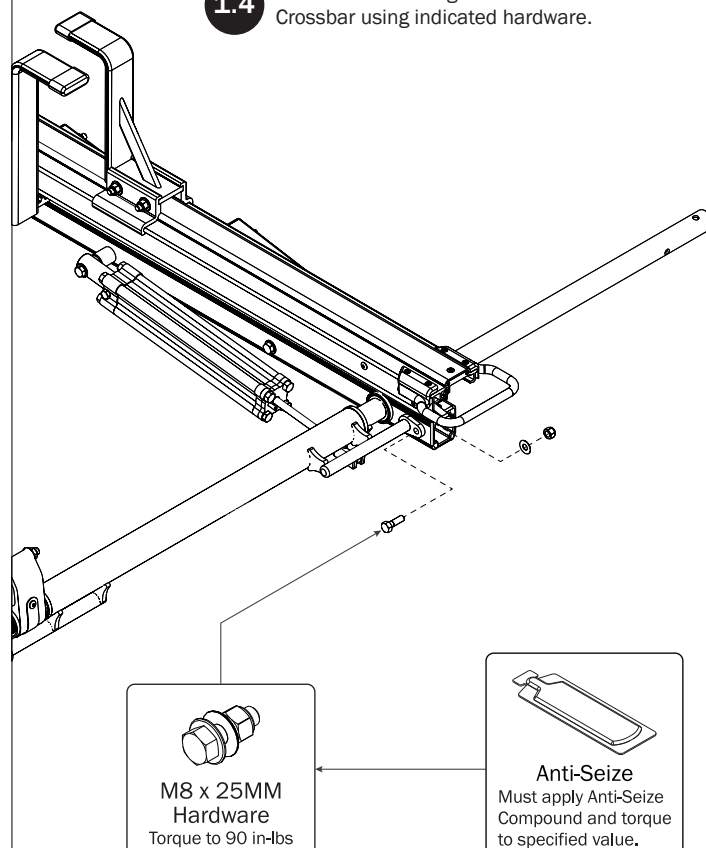
**REAR DRIVE SHAFT
EXCEPT 99.00" CROSSBAR SIZING****1.4** Attach HHR Housing Anchor to Rear Crossbar using indicated hardware.

REAR DRIVE SHAFT: 99.00" CROSSBAR SIZING ONLY

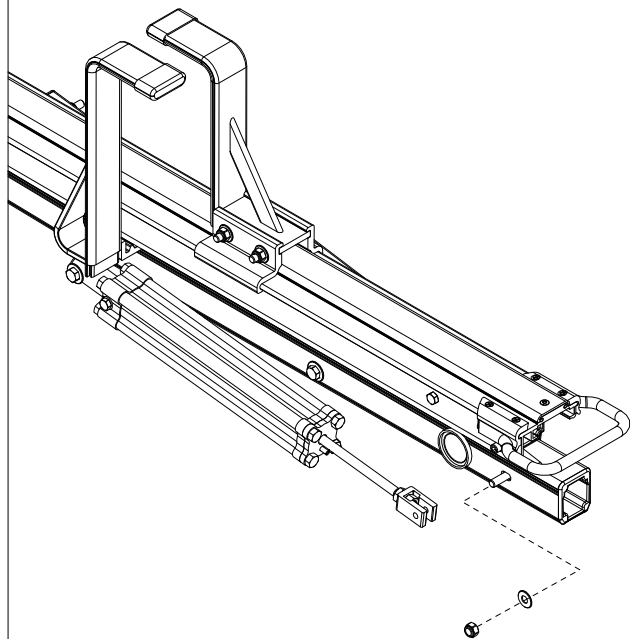

1.1 Remove and save washer and locknut before installing Rear Driveshaft.

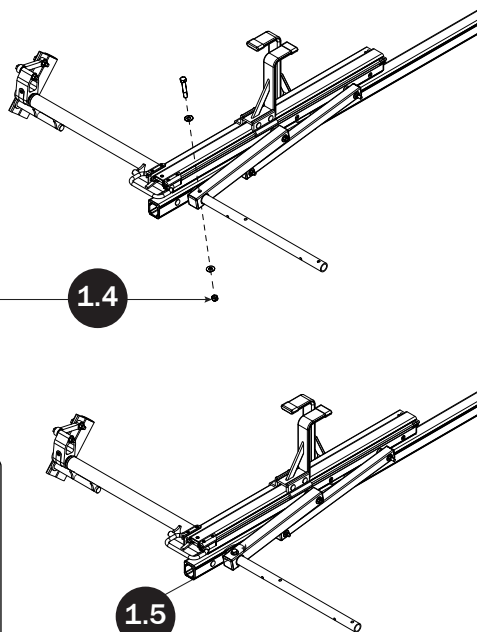
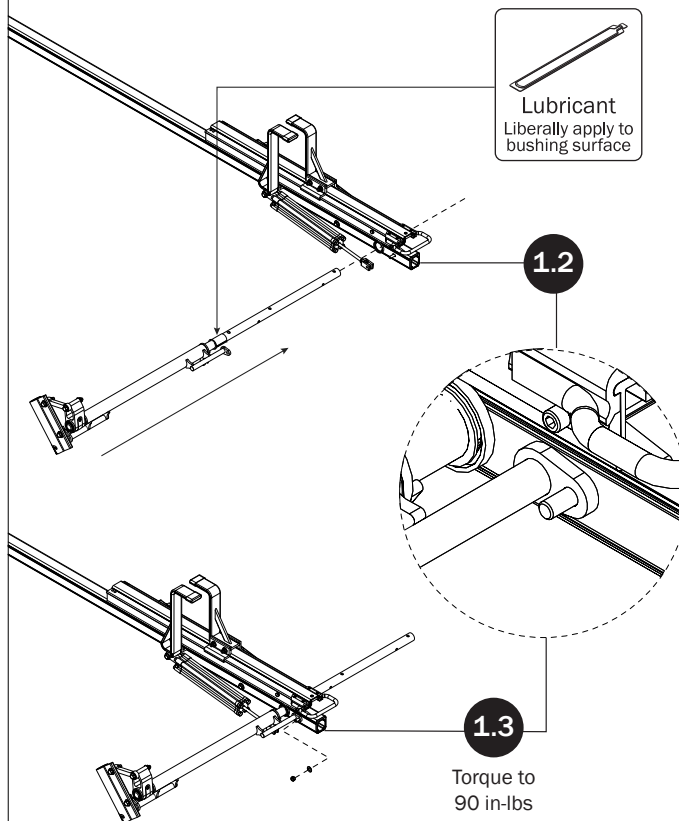

3/8" Hardware
Tight fitting bolt.
Use a ratchet and
9/16" socket to thread
into Drive Shaft

Anti-Seize
Must apply Anti-Seize
Compound and torque
to specified value.

1.5
Torque to
90 in-lbs

CONNECTING BAR VARIATIONS

Distance D	Connect A to:	Connect B to:
6 ft (72")	A2	B2
7 ft (84")	A1	B2
8 ft (96")	A1	B1

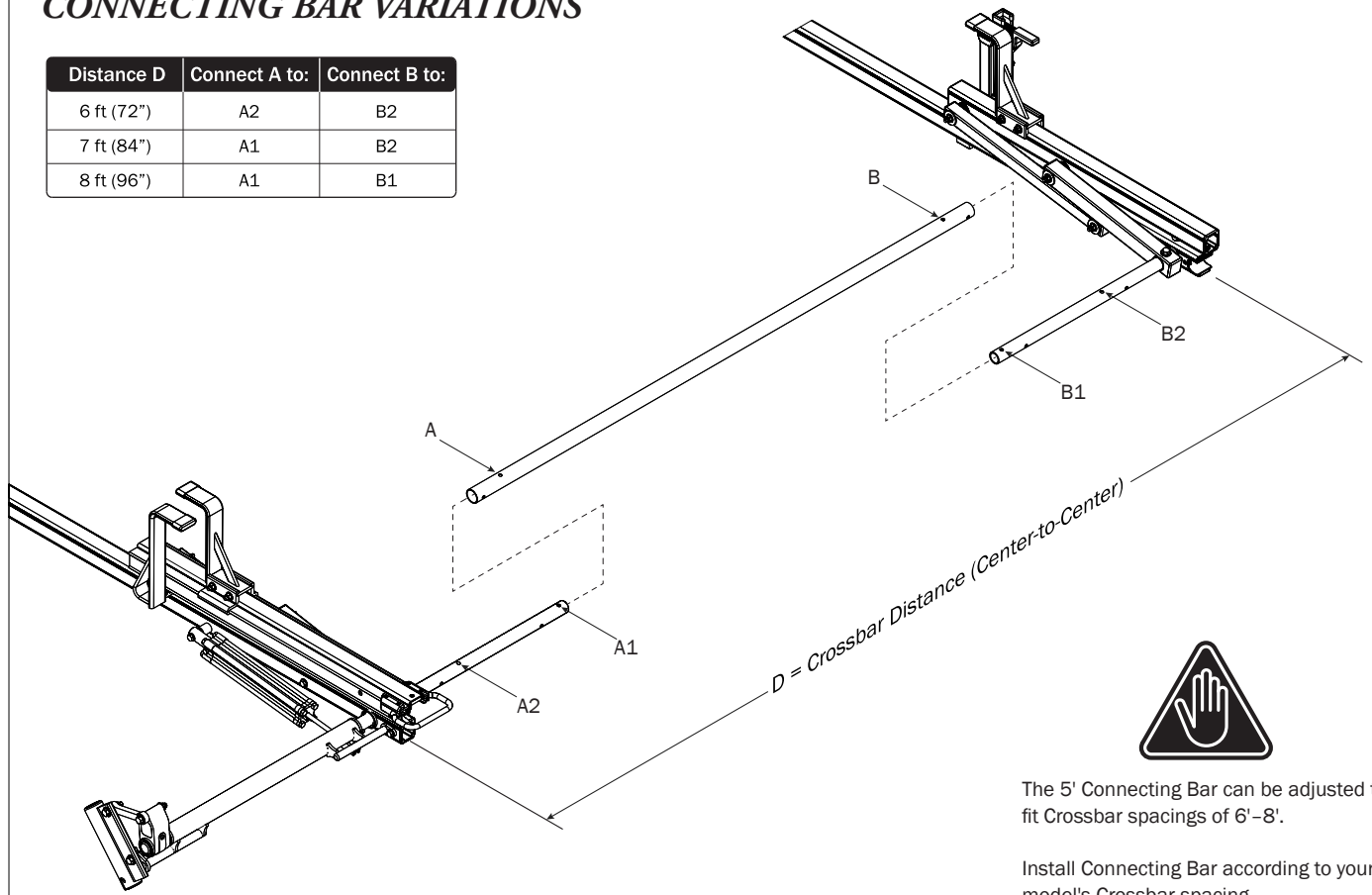
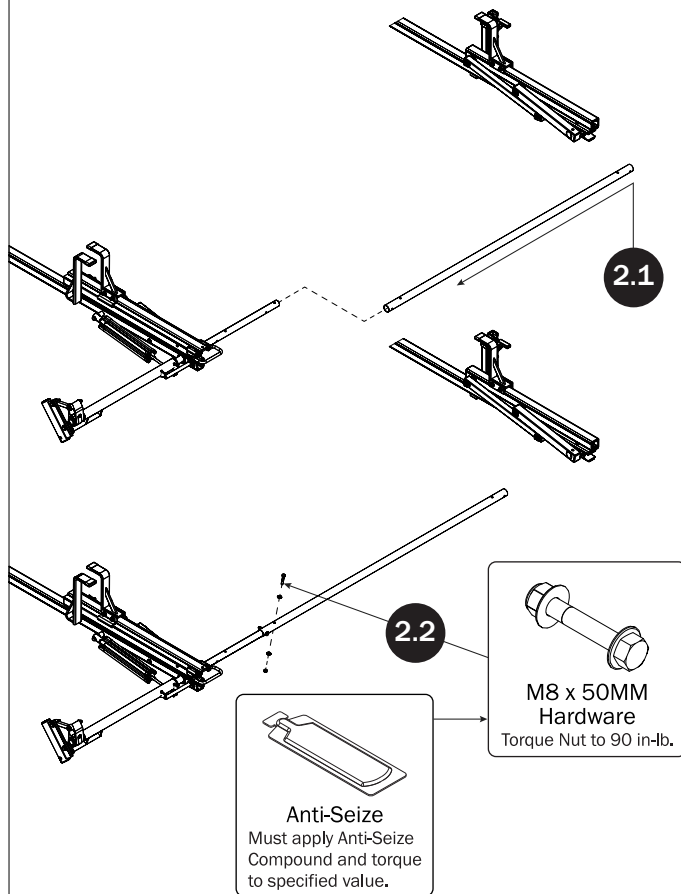
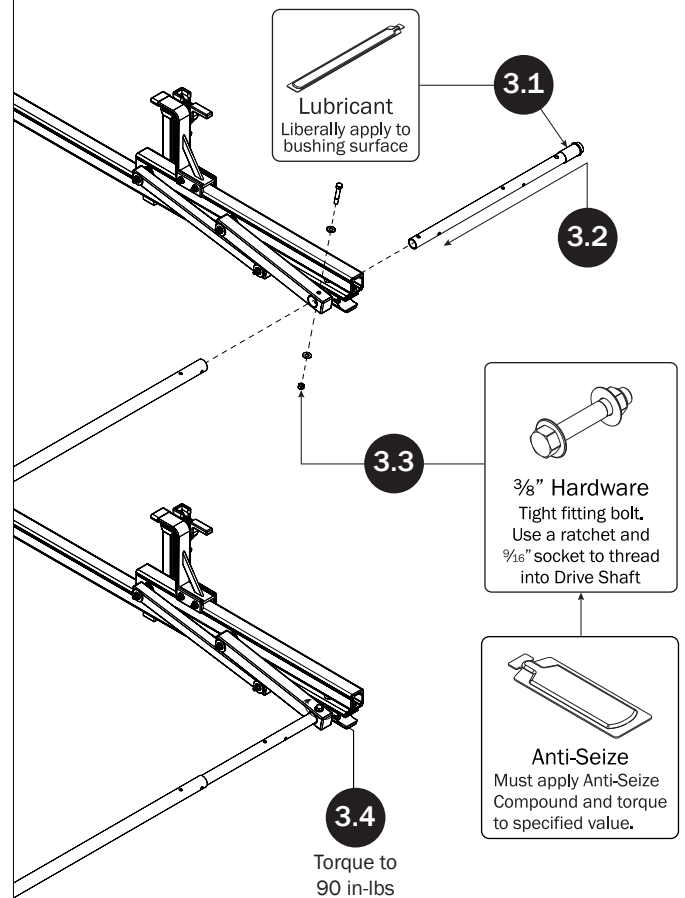
**CONNECTING BAR****FRONT DRIVE SHAFT**

CONNECTING BAR FASTENERS

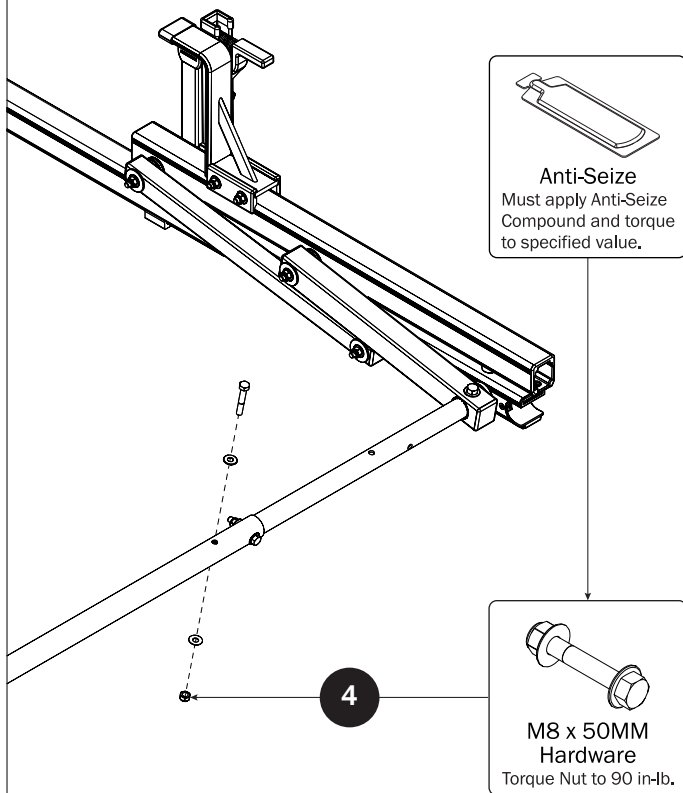

CYLINDER HARDWARE

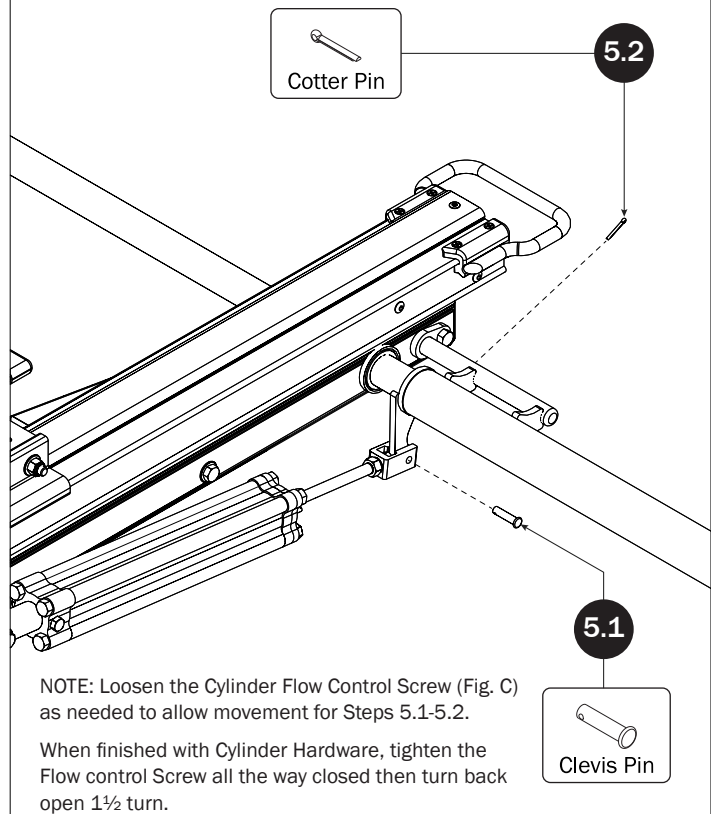

DRIVE SHAFT SEALING

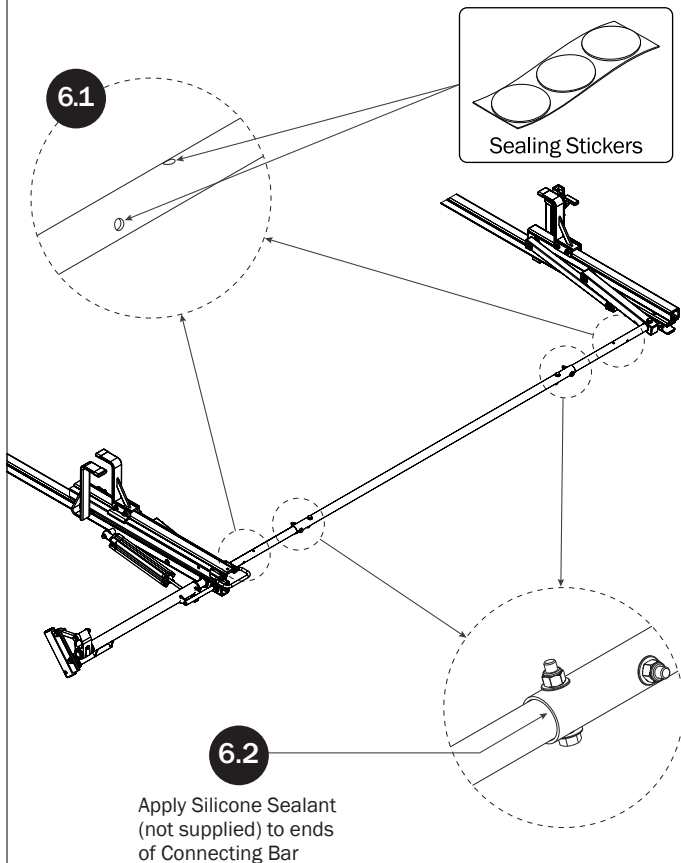

CYLINDER ADJUSTMENT

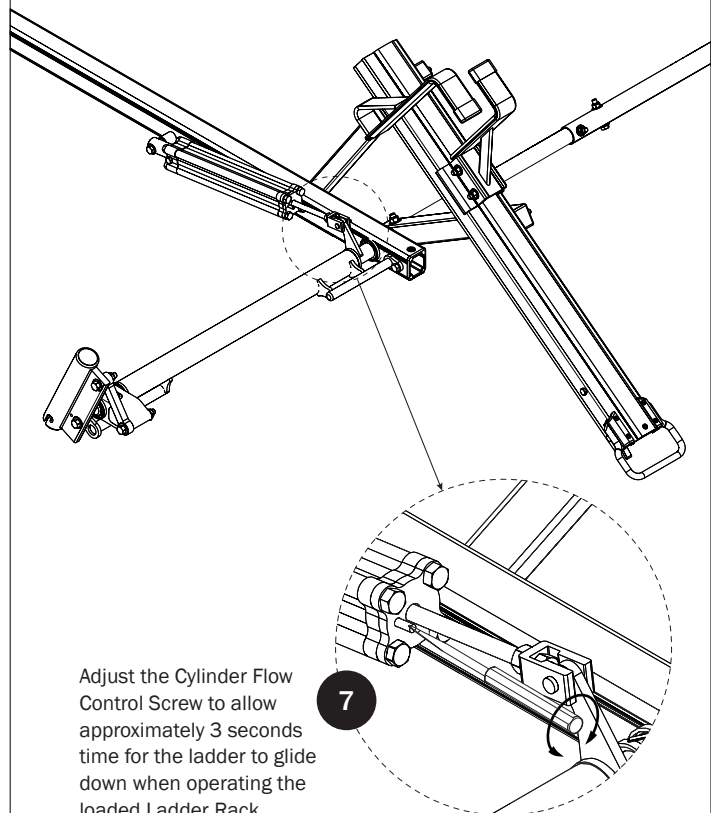

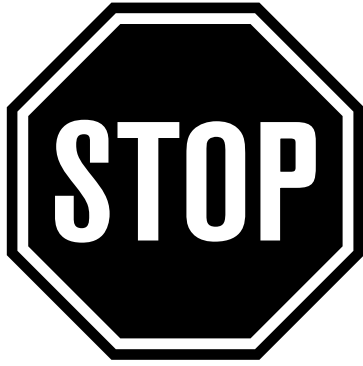

NOTE: This completes the right hand assembling of FEA-0019. For left side Drive Shaft assembly procedures, see FEA-0020 Assembly Manual.

If applicable, refer to your next FEA Assembly Manual.

If completed, refer back to your FBM Assembly Manual, and resume assembling at Step 3.1.

WARNING: Failure to position the Crossbars as shown in your FBM Assembly Manual may result in damage to the sliding door and/or ladder rack.

USAM-FEA0019-US01 Rev-B 0320